



KITSAP COUNTY ASSESSOR

Jim Avery

614 Division St., MS-22, Port Orchard, WA 98366 Phone (360) 337-7160 Fax (360) 337-4874
B.I.: 842-2061 Olalla: 851-4147 Home Page: www.wa.gov/kitsap

Michael Eastman
Chief Deputy

CURRENT USE Pre-application Meeting Request

All items must be filled out, and three (3) copies of the site plan must be submitted with this request. Please see other side of this sheet for site plan requirements. You will receive written notice of your meeting date and time. Your meeting may be scheduled up to 28 days from the time the Assessor receives your request. Any omission will cause a delay in scheduling your meeting. Return to address above.

FOR OFFICIAL USE ONLY

Received by: _____

Receipt #: _____

Requested by:

Applicant

Representative, if applicable

Mailing Address

Mailing Address

City, State, Zip

City, State, Zip

Phone: _____

Phone: _____

Land Classification Applying for: _____

Current Use of Property: _____

Address or location of property: _____

Assessor's Account Number: _____

SITE PLAN REQUIREMENTS

The site plan shall include the following items:

- a. Fit on 8 ½" x 11" sheet of paper
- b. North arrow
- c. Vicinity map
- d. Property line locations and dimensions
- e. Abutting roadways
- f. All existing and proposed easements, roads, and driveways
- g. All existing and proposed building structures
- h. All existing and proposed buffers, open space, fences, sidewalks, paths and parking areas
- i. All existing and proposed drainage facilities
- j. Shorelines, creeks, streams, lakes, ponds, wetlands, and other bodies of water along with their ordinary high water line and associated buffers
- k. Steep slopes greater than 15% and their associated buffers

If you have any questions regarding the required site plan, please contact Scott Sampson, Assessor's Office at 360-337-4859.

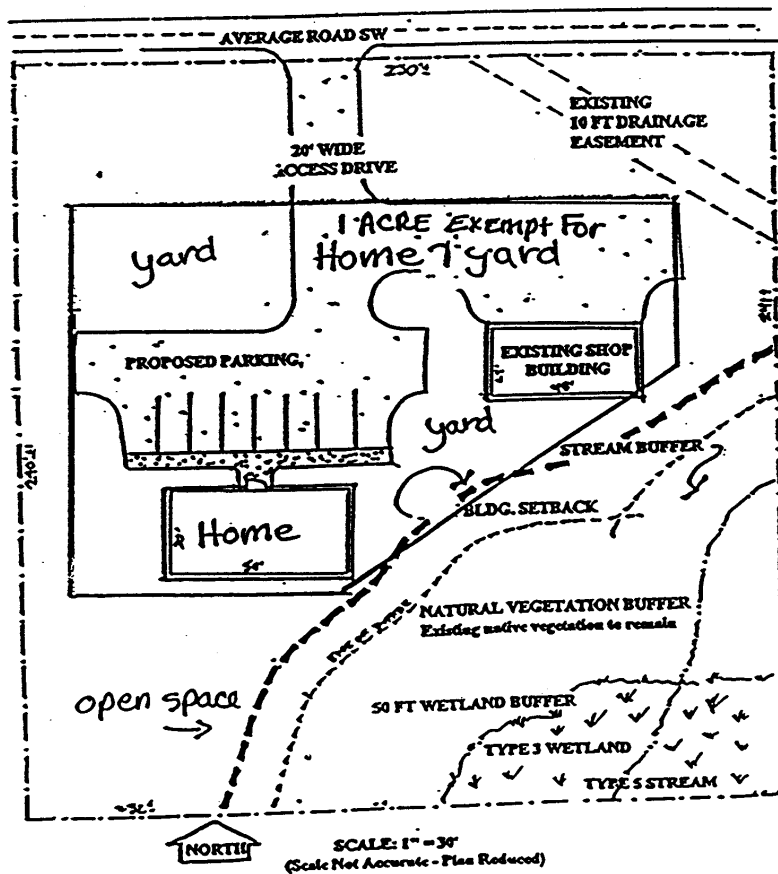

Sample Site Plan